

STANDARD RECOVERY DIODES STUD

YZPST-D860/1800V
Forward Conduction

Parameter	Symbol	Min.	Max.	Typ.	Units	Conditions
Repetitive peak reverse voltage	V_{RRM}			1800	V	
Non repetitive peak reverse voltage	V_{RSM}			1900	V	
Max. average forward current	$I_{F(AV)M}$			860	A	Sinewave, 180° conduction, $T_c=80^{\circ}\text{C}$
Max. RMS forward current	$I_{F(RMS)M}$			1250	A	Nominal value
Max. peak, one-cycle forward, non-repetitive surge current	I_{FSM}			12	kA	10.0 msec (50Hz), half sinewave, $T_{vj} = T_{vj} \text{ max}, V_{RM} = 0.5V_{RRM}$
Maximum I^2t for fusing	I^2t			725	kA^2s	
Max. forward voltage drop	V_{FM}			1.40	V	$I_{FM} = 2600\text{A}; T_{vj} = 25^{\circ}\text{C}$
Threshold voltage	V_{F0}			0.7	V	
Slope resistance	r_T			1.5	$\text{m}\Omega$	

Thermal and Mechanical Specifications

Parameter	Symbol	Min.	Max.	Typ.	Units	Conditions
Operating temperature	T_j	-40	+150		$^{\circ}\text{C}$	
Storage temperature	T_{stg}	-40	+150		$^{\circ}\text{C}$	
Reverse recovery charge	Q_{rr}			-	μC	
Thermal resistance - junction to case	$R_{\Theta(j-c)}$		-	90	$^{\circ}\text{C}/\text{kW}$	
Thermal resistance - case to heatsink	$R_{\Theta(c-s)}$		-	80	$^{\circ}\text{C}/\text{kW}$	
Mounting force	P	-	-	1.7	kN	$\pm 20\%$
Weight	W	-	-	950	g	About
Case style				-		See Outline Table

CASE OUTLINE AND DIMENSIONS.

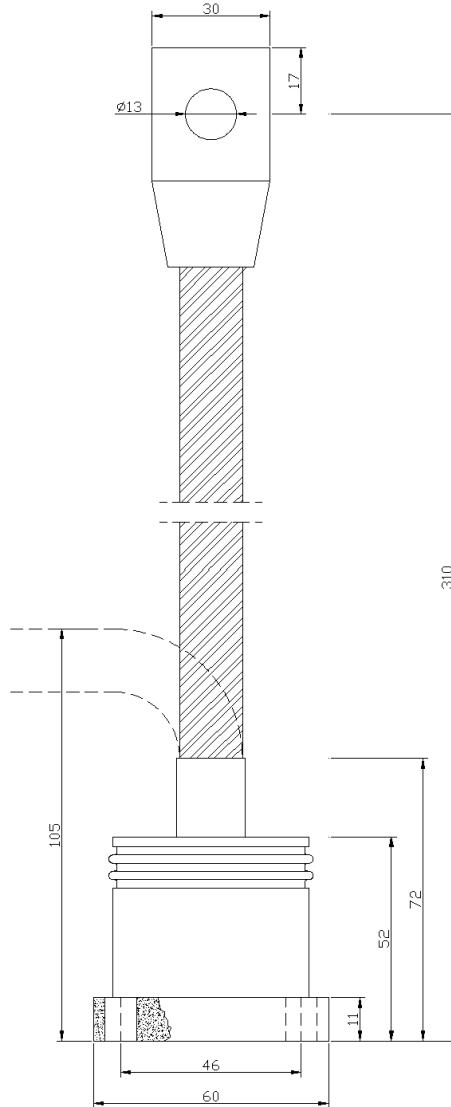

®

Tel: +86-514-87782298, 87782296

FAX: +86-514-87782297, 87367519

E-mail: positioning@china.com;

info@yzpst.com;

yzpst@pst888.com

Web Site: www.Pst888.com

www.yzpstcc.com

www.yzpst.net

www.yzpst.com